



# All Dulles Area Muslim Society (ADAMS)

[www.adamscenter.org](http://www.adamscenter.org)



## ADAMS LOCAL EID PLANS *Flier VERSION 2*

(Arrangement details are subject to change so please check back the day before at [www.adamscenter.org](http://www.adamscenter.org))

### Eid Al-Fitr is on Sunday September 20, 2009

- 1) **On Sun Sept 20, 2009**, ADAMS will be having Eid Prayers at the National Conference Center Lansdowne Sports Center (7:15am, 8:15am, 9:15am, 10:30am, 11:45am), Reston Hyatt Regency(7:15am, 8:15am, 9:30am, 10:45am), Herndon Hyatt Dulles(7:15am, 8:15am, 9:30am, 10:45am), Fairfax Waterford at Fair Oaks(7:45am, 9:00am, 10:15am, 11:30am), and Mclean High School(8:30am, 10:00am, 11:30am)
- 2) Please attend the early prayers, if possible.
- 3) Parking is limited at all locations so we are urging everyone to carpool.
- 4) There will be NO combined Eid Prayer and Celebration in DC this Eid
- 5) ADAMS will **NOT** be praying Eid at the ADAMS Main Center in Sterling in order to not violate parking commitments to neighbors.
- 6) Please donate generously to ADAMS at th Eid Prayers(Suggested Donation of at least \$5 Per Person to cover cost of Eid Expenses)
- 7) Please bring your wudu with you from home and Please Bring your Prayer Rugs.
- 8) **Sun Sep 20 10am-3pm** - Mclean Eid Festival at Mclean High School
- 9) **Sat Sept 26 12-6pm**- ADAMS Main Center in Sterling will have an Eid Festival with Moonbounces, Vendors, Cotton Candy, Popcorn, and Food

**1) National Conference Center - Sports Center (formerly Xerox Center) - Lansdowne, VA (Btwn Sterling and Leesburg) Off of Rt 7 and Belmont Ridge Rd.** -Ashburn, Sterling, Leesburg, Loudoun Residents should attend this prayer  
 1<sup>st</sup> Prayer and Khutba – 7:15am - Capacity 1000 People - 300 car parking spaces available – Please carpool  
 2<sup>nd</sup> Prayer and Khutba – 8:15am – Capacity 1000 People - 300 car parking spaces available – Please carpool  
 3<sup>rd</sup> Prayer and Khutba – 9:15am - Capacity 1000 People - 300 car parking spaces available – Please carpool  
 4th Prayer and Khutba – 10:30am - Capacity 1000 People - 300 car parking spaces available – Please carpool  
 5th Prayer and Khutba – 11:45am - Capacity 1000 People - 300 car parking spaces available – Please carpool

#### **2) Reston Hyatt Regency – Reston Town Center - 1800 Presidents Street Reston, VA 20190**

North Reston, North Herndon, Great Falls

- 1st Prayer and Khutba – 7:15am - Capacity 600 People - Please carpool
- 2nd Prayer and Khutba – 8:15am – Capacity 600 people - Please carpool
- 3rd Prayer and Khutba – 9:30am – Capacity 600 people - Please carpool
- 4th Prayer and Khutba – 10:45am – Capacity 600 people - Please carpool

#### **3) Herndon Hyatt Dulles – 2300 Dulles Corner Boulevard Herndon, VA 20171**

South Herndon, South Reston, Centreville, Oak Hil, Chantilly – Near - Rt. 28 and Dulles Toll Road

- 1st Prayer and Khutba – 7:15am - Capacity 500 People - Please carpool
- 2nd Prayer and Khutba – 8:15am – Capacity 500 People - Please carpool
- 3rd Prayer and Khutba – 9:30am – Capacity 500 People - Please carpool
- 4th Prayer and Khutba – 10:45am – Capacity 500 People - Please carpool

#### **4) Farifax Waterford Fair Oaks - 12025 Lee Jackson Memorial Highway, Fairfax, VA 22033**

Fairfax, South Riding, Chantilly, Clifton, Gainesville

- 1st Prayer and Khutba – 7:45am - Capacity 700 People - Please carpool
- 2nd Prayer and Khutba – 9:00am - Capacity 700 People - Please carpool
- 3rd Prayer and Khutba – 10:15am – Capacity 700 people - Please carpool
- 4th Prayer and Khutba – 11:30am – Capacity 700 people - Please carpool

#### **5) Mclean High School - 1633 Davidson Rd McLean, VA 22101**

McLean, Vienna, Tysons Corner, Great Falls, Oakton

- 1st Prayer and Khutba – 8:30am - Capacity 500 People - Please carpool
- 2nd Prayer and Khutba – 10:00am - Capacity 500 People - Please carpool
- 3rd Prayer and Khutba – 11:30am – Capacity 500 people - Please carpool
- McLean Eid Festival – 10am-3pm

**DIRECTIONS  
ON BACK**

## Directions

**A) National Conference Center Sport Center( Off of Rt 7 and Belmont Ridge Rd.  
(formerly Xerox Center) - Lansdowne, VA – Between Sterling and Leesburg on Rt 7(Leesburg Pike)**

<http://www.conferencecenter.com/MAPPop.html>

From Main ADAMS Center

- 1) Take Rt 7 West towards Leesburg
- 2) Stay on Rt 7 and Cross over Rt 28
- 3) Take Right on Belmont Ridge Rd (You will see big Xerox Sign and signs to National Conference Center)
- 4) Follow signs to the entrance of The National Conference Center located at the end of Belmont Ridge Rd..
- 5) Pass thru the Security Gatehouse **and say you are with ADAMS** and follow directions to Parking Lots A and B
- 6a) Walk East to Gym for Eid Prayer
- 6b) If you have elderly/handicap to drop off please go left(one way) on Loop Road Circle to gym, then park in Parking Lot A or Lot B

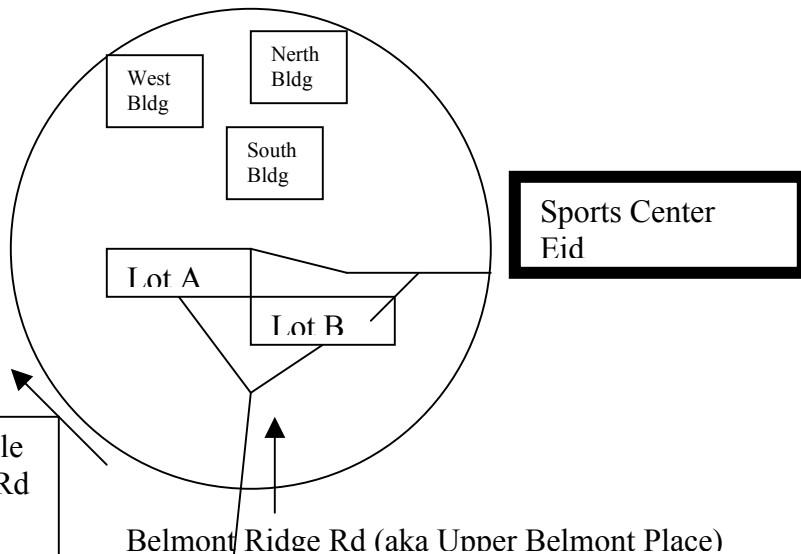

The Circle  
is Loop Rd  
It is One  
Way

**B) Reston Hyatt Regency- Reston Town Center - 1800 Presidents Street Reston, VA 20190**

**From Dulles Toll Road,** Take Exit 12, Reston Parkway / VA 602 and go North on to Reston Parkway. Third traffic light turn left onto Bluemont Way. Turn right onto Presidents Street to our Northern VA hotel.

**C) Herndon Hyatt Dulles — 2300 Dulles Corner Boulevard Herndon, VA 20171 - Near - Rt. 28 and Dulles Toll Road**

**From Dulles Toll Road,** take Exit 10, Herndon/Chantilly. Go South onto Centreville Road. Go 3 traffic lights to Sunrise Valley Drive, Turn right. Go 1.5 miles and the hotel is on your right.

**From Hwy 50:** Go North on VA-28 for 4.6 miles. Turn right on Frying Pan Rd. Go half mile. Turn left on Sunrise Valley Drive. Go one mile. Turn left onto Dulles Corner Blvd. Hotel is on right.

**D) Fairfax Waterford at Fair Oaks- 12025 Lee Jackson Memorial Highway, Fairfax, VA 22033**

**From Fairfax County Parkway (Rte. 7100) and Rte. 50 East:** Take Rte. 50 East past the West Ox Road exit. Take the next right into the Fair Oaks Mall property. Turn right at the stop sign. Turn right at the Extend Stay America Hotel. Waterford at Fair Oaks is next to the hotel.

**E) Mclean High School - 1633 Davidson Rd McLean, VA 22101**

**From Dulles Toll,** Take VA-123 N/DOLLEY MADISON BLVD via EXIT 19B toward MCLEAN; Turn RIGHT onto GREAT FALLS ST/VA-694; Turn LEFT onto CHAIN BRIDGE RD; Turn RIGHT onto DAVIDSON RD.